

NEW

SIP HD Fastener

Structural Insulated Panel Fastener
Heavy Duty

SIP HD Fastener

TRUFAST SIP HD (Heavy Duty) Fastener is designed to attach structural insulated panels (SIP) and plywood or OSB faced composite boards to steel purlins and bar joists.

- #3 Square Drive Bit in each container
- Low profile, pancake head provides excellent pull-through resistance
- Special drop-nose drill point designed to drill and tap nested steel purlins (16-10 ga.) or bar joists (max. 1/4" thick)
- Spiral grooved threads to minimize binding torque
- Large diameter wire for increased shear resistance
- Available in 6", 8", 9 3/4", 11 3/4", 13 3/4" lengths



SIP HD Fastener

Part No.	Screw Length	Pieces Pail/Box	Pail Size	Weight Pail/Box
SIPHD-6000	6"	500	2 Gal.	17 lbs.
SIPHD-8000	8"	250	2 Gal.	22 lbs.
SIPHD-9750	9-3/4"	250	4 Gal.	26 lbs.
SIPHD-11750	11-3/4"	250	4 Gal.	31 lbs.
SIPHD-13750	13-3/4"	250	Box	36 lbs.

Physical Property	Substrate	Mean Ultimate Test Value
Shear Strength		3200 lbs.
Head Pull-Through Resistance	12"x12"x6" thick SIP Panel 7/16" OSB skins with EPS core	920 lbs.
Pull-Out Resistance	16 ga.	1000 lbs.
	13 ga.	1500 lbs.

Installation Instructions: Fasteners should be installed using a maximum 2500 rpm screw gun having a minimum 6.5 amp motor. When fastening structural insulated panels to thick bar joists, it may be necessary to reduce speed of screw gun (i.e. 1500-2000 rpm) to facilitate drilling. Fasteners should never be struck with a hammer during installation.

SCREW SELECTION GUIDE		
Screw Length	Min. Grip Length	Max. Grip Length
6"	2 1/8"	5 1/4"
8"	4 1/8"	7 1/4"
9 3/4"	5 7/8"	9"
11 3/4"	7 7/8"	11"
13 3/4"	9 7/8"	13"

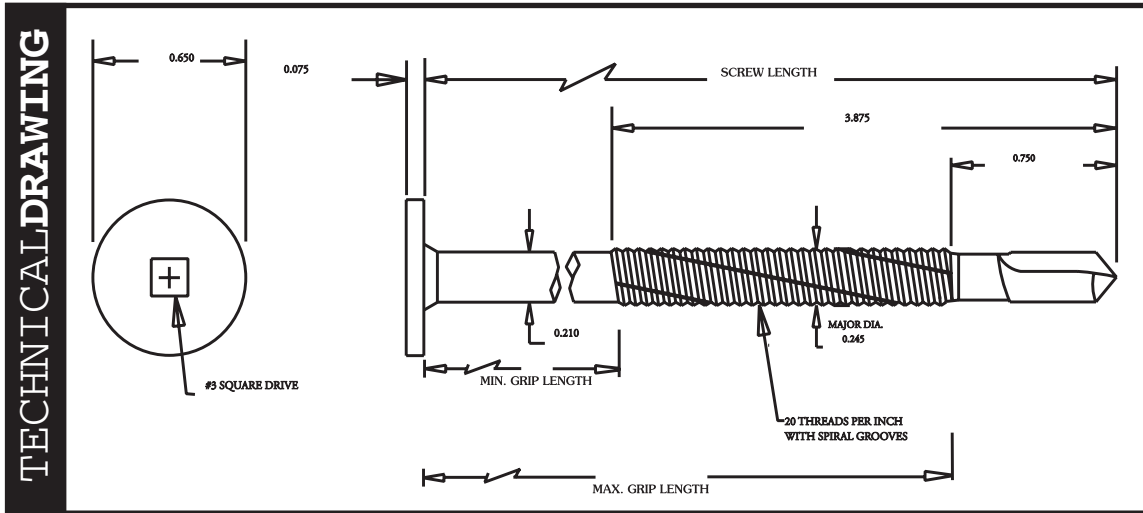
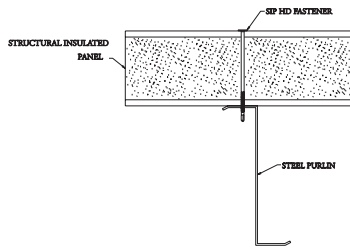

THE TRUFAST CORPORATION DISCLAIMER/LIMITED WARRANTY TRUFAST SCREWS AND TRUFAST PLATES

TRUFAST hereby gives to the original purchaser/owner only, a warranty for (10) years from date of purchase against loss of satisfactory holding ability of the TRUFAST Screws and/or Plates (TRUFAST Products) in construction applications (System) as a result of corrosion and/or deterioration of the TRUFAST Products.

NOTICE: Notification of a claim under this warranty must be submitted in writing thirty (30) days after discovery of a warranted defect to TRUFAST Corporation, 02105 Williams Cty. Rd. 12-C, Bryan, Ohio 43506-9804, together with evidence of the original shipment date and invoice price. Upon such notification, TRUFAST will examine, or cause to be examined, the products in question, without unreasonable delay.

RECURSE: Purchaser's exclusive remedy for breach of said warranty shall be as follows: IF AND ONLY IF, TRUFAST PRODUCTS SHOULD FAIL TO RETAIN SATISFACTORY HOLDING ABILITY UNDER THE CONDITIONS DESCRIBED HEREIN, TRUFAST WILL ONLY REPLACE THE DEFECTIVE PRODUCTS.

EXCLUSIONS: This warranty shall not apply if:

- (1) The integrity of the Screws and/or Plates is damaged during installation or otherwise;
- (2) The System has not been properly installed and maintained;
- (3) The System components have not been installed and maintained to prevent corrosion and/or deterioration due to moisture or chemicals prior to, during, and after construction;
- (4) TRUFAST Products have been repaired or altered in any way by persons other than TRUFAST's authorized service personnel;
- (5) There is any damage resulting from accident, acts of God, alteration, negligence, misuse or abuse;
- (6) Depreciation or deterioration of building materials and/or roofing system components other than TRUFAST Products are a factor in or have contributed to the loss of satisfactory holding ability of the TRUFAST Products; or
- (7) TRUFAST Products are not installed with good workmanship or not in accordance with the then current Factory Mutual System application patterns, specifications, and procedures or not in accordance with TRUFAST then current specifications for installation and maintenance of such Systems.

TRUFAST LITERATURE: The performance specifications listed in TRUFAST's literature are based on controlled laboratory tests and should not be relied upon except as a guideline since building design, engineering, and construction, as well as workmanship and materials of the System, are beyond the control of TRUFAST.

The foregoing warranty is IN LIEU OF ALL OTHER WARRANTIES, EXPRESS, IMPLIED OR STATUTORY, INCLUDING BUT NOT LIMITED TO WARRANTIES OF MERCHANTABILITY AND FITNESS FOR A PARTICULAR PURPOSE. THE FOREGOING WARRANTY IS ALSO IN LIEU OF ANY OTHER OBLIGATIONS AND LIABILITIES ON THE PART OF TRUFAST AND ALL OTHER WARRANTIES ARE EXPRESSLY EXCLUDED. TRUFAST NEITHER ASSUMES NOR AUTHORIZES ANY PERSON TO ASSUME FOR IT ANY OTHER OBLIGATION OR LIABILITY WHATSOEVER IN CONNECTION WITH THE FASTENING PRODUCTS, ROOFING SYSTEM, OR CONSTRUCTION IN NO EVENT SHALL TRUFAST BE LIABLE FOR SUCH SPECIAL, CONSEQUENTIAL, OR INCIDENTAL DAMAGES FOR BREACH OF SAID WARRANTY NOR FOR IMPROPER SELECTION OF TRUFAST PRODUCTS FOR A PARTICULAR APPLICATION.



TRUFAST CORPORATION

02105 Williams Cty. Rd. 12-C

Shipping: S.R.#2 and U.S. Hwy.#6

Bryan, Ohio 43506-9804

1-800-443-9602 • 419-636-6715

Fax: 419-636-1784

WebSite: www.trufast.com

E-mail: trufast@bright.net