

#8x1 1/2" SCREWS @ 8" O.C. OR 8d NAILS @ 6" O.C. TOP AND BOTTOM OF SUBFASCIA (U.N.O.)

#8x1 1/2" SCREWS OR 8d NAILS @ 12" O.C. FASTENED IN ROOF SHEATHING

7/16" OSB ROOF SHEATHING

TRUFAST SCREWS W/ WASHERS @ 12" O.C. W/ MINIMUM 1" PENETRATION INTO TOP PLATE MATERIAL (U.N.O.)

LAMIT ROOF PANEL

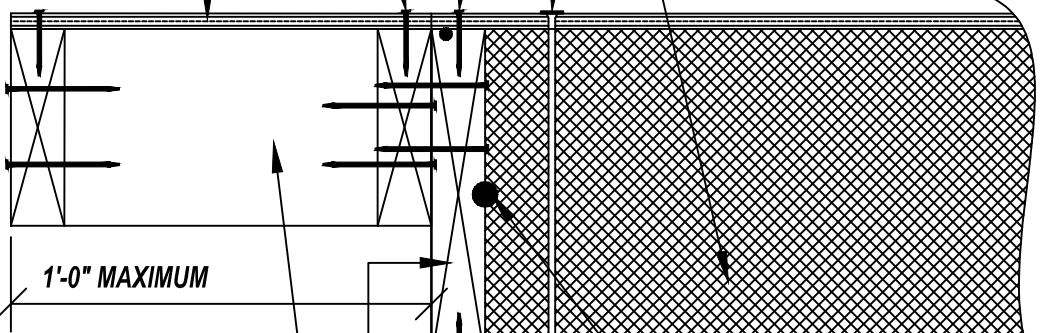

1'-0" MAXIMUM

2x LADDER FRAMING OVERHANG ATTACHED TOGETHER W/ (2) #9x3" SCREWS OR 16d NAILS (U.N.O.)

CONTINUOUS 3/8" & 1/2" PREMIER MASTIC TYPICAL ALONG EDGES

2x ROOF PANEL SUBFASCIA -- ATTACH OVERHANG TO SUBFASCIA W/ #9x3" SCREWS OR 16d NAILS @ 12" O.C. IN 2 ROWS STAGGERED THROUGH THE BACKSIDE OF THE SUBFASCIA BEFORE BEING INSTALLED INTO ROOF PANEL (U.N.O.)

SIP TAPE ON WARM SIDE OF PANEL

2x TOP PLATE

LAMIT WALL PANEL

**NOTE: MAXIMUM 42# LIVE LOAD**

## RAFTER TAIL RAKE (OPTIONAL)

DETAIL NUMBER:

**1416**

**SCALE : NTS**

**Updated: 3/17/2017**

**LAMIT INDUSTRIES**

**STRUCTURAL INSULATED PANELS  
FOR THE BUILDING INDUSTRY**