

CAP PLATE
STANDARD 2x LUMBER,
1 1/8" OSB, OR 1 1/8" OSL
(RIMBOARD) WHICH HAS
BEEEN RIPPED TO OVERALL
WIDTH OF PANEL, MAY BE
USED TO INCREASE WALL
HEIGHT OR TO INCREASE
POINT LOADING CAPACITY.

12d OR 16d
NAILS @ 12" O.C.
U.N.O.

SEALANT
TYPICAL EACH
SIDE AND BOTTOM

8d NAILS @ 6" O.C.
OR EQUIVALENT
EACH SIDE. U.N.O.

FIELD INSTALL
PANEL TOP AND
BOTTOM PLATES

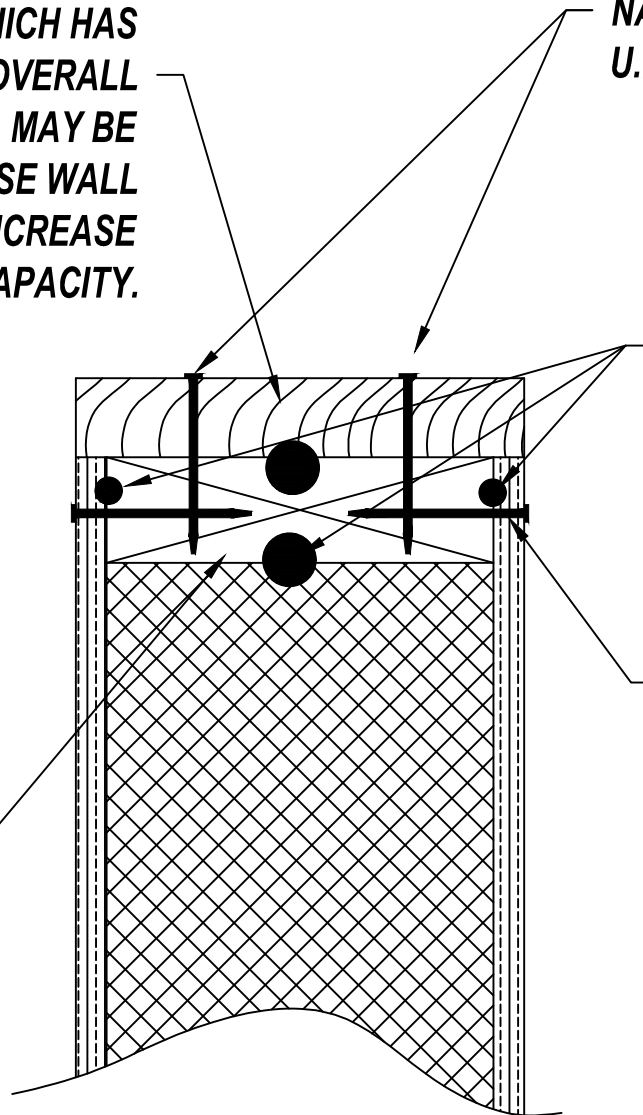

CAP PLATE

DETAIL NUMBER:

1116

SCALE : NTS

Updated: 2/22/2017

LAMIT INDUSTRIES

STRUCTURAL INSULATED PANELS
FOR THE BUILDING INDUSTRY