

**INSTALLATION SEQUENCE:**

**TO ATTACH LEDGER TO WALL PANELS USE SUBFLOOR ADHESIVE AND 2 ROWS OF 3 1/8" RSS SCREWS SPACED @ 24" O.C. STAGGERED (U.N.O. PER ENGINEER) -- THEN USE 2 ROWS OF PANEL SCREWS FROM INTERIOR OF WALL @ 12" O.C. STAGGERED (U.N.O. PER ENGINEER)**

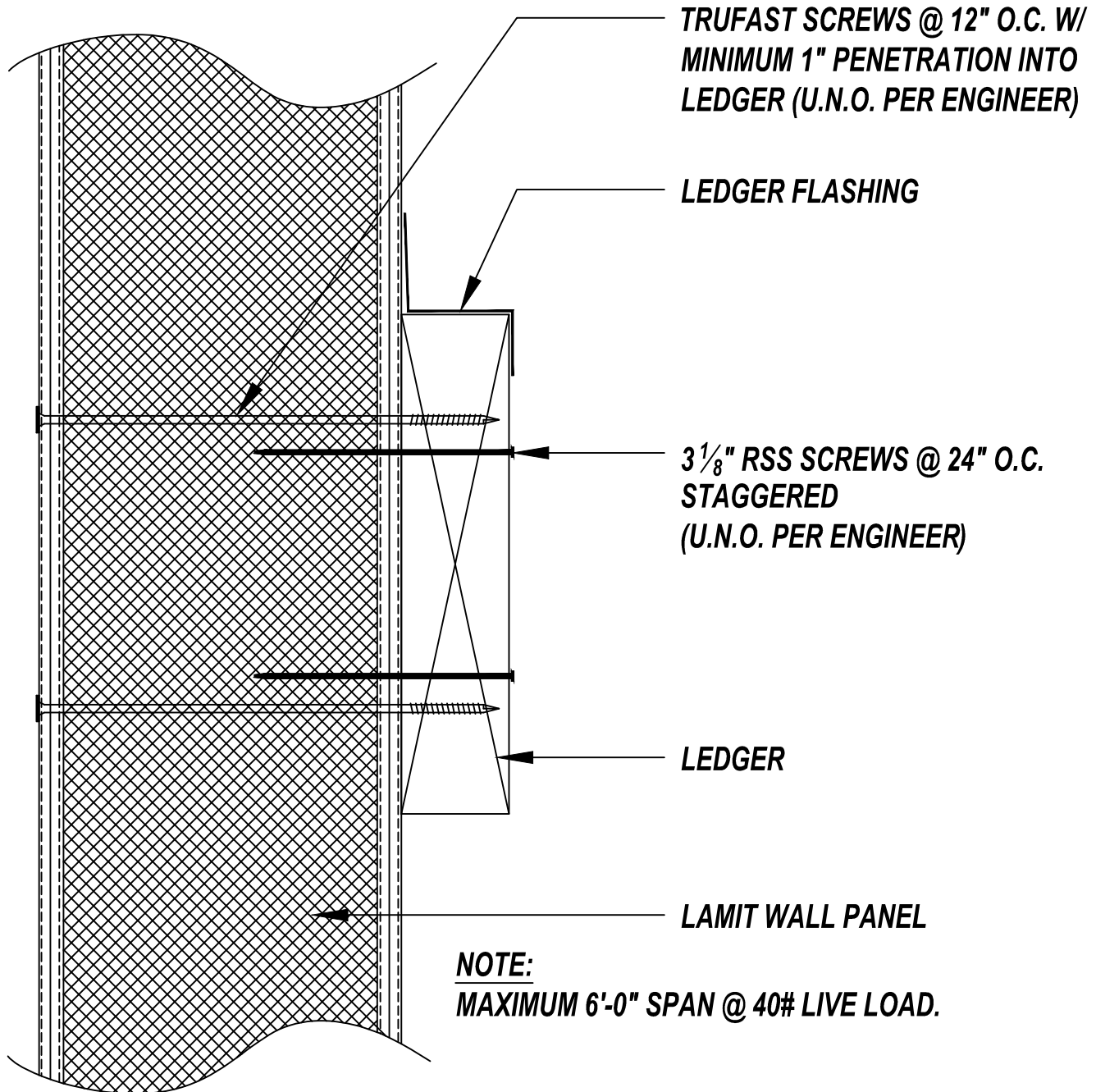

**LEDGER ATTACHMENT**

DETAIL NUMBER:

**1107**

**SCALE : NTS**

**Updated: 3/17/2017**

**LAMIT INDUSTRIES**

**STRUCTURAL INSULATED PANELS  
FOR THE BUILDING INDUSTRY**